



महाराष्ट्र शासन
जलसंपदा विभाग

कनिष्ठ अभियंता (स्थापत्य) गट-ब (अराजपत्रित) सरळसेवा परीक्षा-२०१९

Participant ID	
Participant Name	
Test Center Name	iON DIGITAL Zone iDZ Vishnupuri
Test Date	09/08/2022
Test Time	12:30 PM - 2:00 PM
Subject	Cluster 1

Section : English

Q.1 Select the most appropriate option to fill in the blank.

He copied my paper word _____ word so the teacher cancelled it.

- Ans
- 1. on
 - 2. in
 - 3. for
 - 4. to

Question Type : MCQ

Question ID : 387868410

Option 1 ID : 3878681607

Option 2 ID : 3878681608

Option 3 ID : 3878681605

Option 4 ID : 3878681606

Status : Marked For Review

Chosen Option : 4

Q.2 Select the most appropriate option to fill in the blank.

Our house in Shimla _____ to be a summer resort.

- Ans
- 1. intended
 - 2. was intended
 - 3. was being
 - 4. had intended

Question Type : MCQ

Question ID : 387868411

Option 1 ID : 3878681609

Option 2 ID : 3878681612

Option 3 ID : 3878681611

Option 4 ID : 3878681610

Status : Answered

Chosen Option : 1

Q.3 Select the most appropriate synonym of the given word.

Denounce

- Ans 1. Revile
 2. Flatter
 3. Ignore
 4. Applaud

Question Type : MCQ
Question ID : 387868413
Option 1 ID : 3878681618
Option 2 ID : 3878681620
Option 3 ID : 3878681619
Option 4 ID : 3878681617
Status : Answered
Chosen Option : 1

Q.4 Sentences of a paragraph are given below in jumbled order. Arrange the sentences in the correct order to form a meaningful and coherent paragraph.

- A.The more TV they watch, the more they tend to eat things that are advertised on TV.
B.Paediatricians recommend that children should not watch TV for more than one to two hours per day
C.Thus, US nutrition experts have come to the conclusion that watching too much TV is one of the main reasons why so many children in the US are overweight.
D.Unfortunately, this usually means high-fat snacks, potato crisps or chocolate.

- Ans 1. BDCA
 2. ACBD
 3. CBAD
 4. BADC

Question Type : MCQ
Question ID : 387868415
Option 1 ID : 3878681625
Option 2 ID : 3878681627
Option 3 ID : 3878681628
Option 4 ID : 3878681626
Status : Answered
Chosen Option : 4

Q.5 Select the most appropriate meaning of the given idiom.

Lose ground

- Ans 1. Fall behind
 2. Lack faith
 3. Reduce speed
 4. Miss a chance

Question Type : MCQ
Question ID : 387868414
Option 1 ID : 3878681623
Option 2 ID : 3878681622
Option 3 ID : 3878681624
Option 4 ID : 3878681621
Status : Marked For Review
Chosen Option : 2

Q.6 Select the most appropriate ANTONYM of the given word.

Lavish

- Ans 1. Generous
 2. Lacking
 3. Liberal
 4. Wasteful

Question Type : MCQ

Question ID : 387868412

Option 1 ID : 3878681616

Option 2 ID : 3878681615

Option 3 ID : 3878681614

Option 4 ID : 3878681613

Status : Marked For Review

Chosen Option : 1

Q.7 Select the most appropriate option to fill in the blank.

I am _____surprised at the result.

- Ans 1. very much
 2. quite
 3. too much
 4. enough

Question Type : MCQ

Question ID : 387868409

Option 1 ID : 3878681601

Option 2 ID : 3878681603

Option 3 ID : 3878681602

Option 4 ID : 3878681604

Status : Marked For Review

Chosen Option : 1

Adda247

Comprehension:

Read the given passage and answer the questions that follow.

Last summer, I boarded a flight from the IGI airport. The airplane waited at the runway in a queue to take off for one hour, with the engines running. A lot of aviation fuel was wasted. Carbon dioxide, nitrogen oxide and water vapour were released into the atmosphere.

With the entry of many players in the aviation industry, pollution has reached the skies as well. With the number of airline flights worldwide growing and expected to skyrocket over the coming decades, the problem of delayed arrival and departure will intensify.

The inefficiencies in the air and on the ground caused by the system also mean wastage of fuel and excessive emission of CO₂. No doubt, the air travel industry is coming under scrutiny for its role in climate change. Though the aviation industry contributes only 2% of the total C-emissions, with the rapid economic growth and ever increasing affordability of air travel, this industry will only expand at a much faster pace than ever before, thus increasing the rate of carbon emissions.

SubQuestion No : 8

Q.8 What do the inefficiencies in the air and on the ground result in?

- Ans
- 1. Wastage of fuel and excessive CO₂ emissions
 - 2. Increase in the number of flights
 - 3. Rapid economic growth and accessibility of air travel
 - 4. Rapid expansion of airlines worldwide

Question Type : MCQ

Question ID : 387868419

Option 1 ID : 3878681637

Option 2 ID : 3878681638

Option 3 ID : 3878681640

Option 4 ID : 3878681639

Status : Answered

Chosen Option : 1

Adda247

Comprehension:

Read the given passage and answer the questions that follow.

Last summer, I boarded a flight from the IGI airport. The airplane waited at the runway in a queue to take off for one hour, with the engines running. A lot of aviation fuel was wasted. Carbon dioxide, nitrogen oxide and water vapour were released into the atmosphere. With the entry of many players in the aviation industry, pollution has reached the skies as well. With the number of airline flights worldwide growing and expected to skyrocket over the coming decades, the problem of delayed arrival and departure will intensify. The inefficiencies in the air and on the ground caused by the system also mean wastage of fuel and excessive emission of CO₂. No doubt, the air travel industry is coming under scrutiny for its role in climate change. Though the aviation industry contributes only 2% of the total C-emissions, with the rapid economic growth and ever increasing affordability of air travel, this industry will only expand at a much faster pace than ever before, thus increasing the rate of carbon emissions.

SubQuestion No : 9

Q.9 Which of the following statements is NOT true?

- Ans**
- 1. Delayed departures and arrivals lead to wastage of fuel.
 - 2. Engines are kept running when planes await take off on the runway.
 - 3. Every minute saved from a flight means fuel saved and carbon emission averted.
 - 4. Aviation industry contributes only 20% of the total carbon emission.

Question Type : MCQ

Question ID : 387868418

Option 1 ID : 3878681634

Option 2 ID : 3878681633

Option 3 ID : 3878681635

Option 4 ID : 3878681636

Status : Answered

Chosen Option : 4

Adda247

Comprehension:

Read the given passage and answer the questions that follow.

Last summer, I boarded a flight from the IGI airport. The airplane waited at the runway in a queue to take off for one hour, with the engines running. A lot of aviation fuel was wasted. Carbon dioxide, nitrogen oxide and water vapour were released into the atmosphere. With the entry of many players in the aviation industry, pollution has reached the skies as well. With the number of airline flights worldwide growing and expected to skyrocket over the coming decades, the problem of delayed arrival and departure will intensify. The inefficiencies in the air and on the ground caused by the system also mean wastage of fuel and excessive emission of CO₂. No doubt, the air travel industry is coming under scrutiny for its role in climate change. Though the aviation industry contributes only 2% of the total C-emissions, with the rapid economic growth and ever increasing affordability of air travel, this industry will only expand at a much faster pace than ever before, thus increasing the rate of carbon emissions.

SubQuestion No : 10

Q.10 What is the result of several players emerging in the aviation industry?

- Ans
- 1. Greater penalty on travel industry for climate change
 - 2. More waiting time at the airport
 - 3. Pollution reaching the skies
 - 4. Increasing affordability of air travel

Question Type : MCQ

Question ID : 387868417

Option 1 ID : 3878681632

Option 2 ID : 3878681629

Option 3 ID : 3878681631

Option 4 ID : 3878681630

Status : Answered

Chosen Option : 3

Section : Marathi

Q.11 'ढग' या शब्दाचा समानार्थी शब्द लिहा.

- Ans
- 1. अंबुज
 - 2. अंबर
 - 3. अंबा
 - 4. अंबुद

Question Type : MCQ

Question ID : 387868424

Option 1 ID : 3878681657

Option 2 ID : 3878681659

Option 3 ID : 3878681658

Option 4 ID : 3878681660

Status : Answered

Chosen Option : 1

Q.12 'विधायक' या शब्दाचा विरुद्धार्थी शब्द सांगा.

- Ans 1. विसंगत
 2. विध्वंसक
 3. विसंवादी
 4. विजातीय

Question Type : MCQ
Question ID : 387868423
Option 1 ID : 3878681655
Option 2 ID : 3878681654
Option 3 ID : 3878681653
Option 4 ID : 3878681656
Status : Answered
Chosen Option : 3

Q.13 वर्दळीवर येणे या वाक्यप्रचाराचा अर्थ शोधा.

- Ans 1. वेड पांघरणे
 2. विल्हेवाट लावणे
 3. गर्दी जमवणे
 4. भांडण्यास प्रवृत्त होणे

Question Type : MCQ
Question ID : 387868425
Option 1 ID : 3878681661
Option 2 ID : 3878681662
Option 3 ID : 3878681663
Option 4 ID : 3878681664
Status : Marked For Review
Chosen Option : 4

Q.14 तो मुलगा खेळत आहे. या वाक्यातील काळ ओळखा.

- Ans 1. साधा वर्तमान काळ
 2. अपूर्ण वर्तमान काळ
 3. अपूर्ण भविष्य काळ
 4. अपूर्ण भूतकाळ

Question Type : MCQ
Question ID : 387868422
Option 1 ID : 3878681651
Option 2 ID : 3878681649
Option 3 ID : 3878681652
Option 4 ID : 3878681650
Status : Marked For Review
Chosen Option : 2

Q.15 बागेमध्ये सुंदर ,लाल फुले आणि गोड गोड फळे आहेत. या वाक्यातील विशेषणे ओळखा.

- Ans 1. सुंदर,लाल,गोड
 2. सुंदर ,लाल, बागेत
 3. बाग, फुले ,आहेत
 4. फळे,फुले,सुंदर

Question Type : MCQ
Question ID : 387868420
Option 1 ID : 3878681642
Option 2 ID : 3878681644
Option 3 ID : 3878681641
Option 4 ID : 3878681643
Status : Answered
Chosen Option : 1

Q.16 त्याला खूप समजावून सांगितले, पण तो ऐकत नाही. या वाक्यातील अव्यय शोधा.

- Ans 1. पण
 2. नाही
 3. खूप
 4. ऐकत

Question Type : MCQ
Question ID : 387868421
Option 1 ID : 3878681647
Option 2 ID : 3878681646
Option 3 ID : 3878681645
Option 4 ID : 3878681648
Status : Answered
Chosen Option : 1

Q.17 पुढीलपैकी अचूक वाक्यरचना कोणती आहे ?

- Ans 1. गोपिकांचे आणि गार्डगुरांचे नादाने कृष्णाच्या बासरीच्या भान हरपून जात असे.
 2. गोपिकांचे भान आणि गार्डगुरांचे बासरीच्या नादाने कृष्णाच्या हरपून जात असे.
 3. गोपिकांचे बासरीच्या नादाने कृष्णाच्या आणि गार्डगुरांचे भान हरपून जात असे.
 4. कृष्णाच्या बासरीच्या नादाने गोपिकांचे आणि गार्डगुरांचे भान हरपून जात असे .

Question Type : MCQ
Question ID : 387868426
Option 1 ID : 3878681667
Option 2 ID : 3878681665
Option 3 ID : 3878681668
Option 4 ID : 3878681666
Status : Answered
Chosen Option : 4

Comprehension:

दिलेला उतारा वाचा आणि पुढील प्रश्नांची उत्तरे द्या.

ज्या निबिड आणि गगनचुंबी जंगलाबद्दल कारवार प्रसिद्ध आहे त्या जंगलाचा आरंभ हल्याळ पासून होतो. आम्ही हल्याळ सोडले आणि आमच्या प्रवासातील रोमहर्षक खंडाला प्रारंभ झाला. येथपासून सरळ कारवारपर्यंत नव्वद मैल एकसारखे लागून राहिलेले प्रचंड जंगल आलटून पालटून सागाचे आणि बांबूचे आहे. कोणते जंगल कोठे संपते आणि कोठून सुरू होते याचा अदमास लागत नाही. त्याखेरीज नाना जातींचे अनेक उत्तुंग वृक्ष या जंगलात गर्दी करून राहिले आहेत. बांबूचे जंगल सुरू झाले की मैल चे मैल बांबूच्या बेटांखेरीज काही आढळत नाही. एवढे बांबू लावले कोणी आणि त्यांची अवाढव्य वाढ झाली तरी कधी या विचाराने मस्तक गरगरू लागते.

या जंगलाचे वैशिष्ट्य म्हणजे बारीकसारीक झाडाझुडपांना उगवायला येथे वाव नसल्याने हा प्रचंड वृक्षसमूह असूनही त्यांची विशेष गुंतागुंत दिसत नाही. वृक्षांची मस्तके दीडशे फुटांवर एकमेकांत गुंतलेली असली तरी तळचा भाग विरळ आणि मोकळा आहे. सागाचे जंगल सुरू झाले आणि हजारो सरळसोट साग शिपायांच्या पलटणी प्रमाणे जिकडेतिकडे दिसू लागले आणि डोळे भांबावून गेले. असे विलक्षण दृश्य इतरत्र क्वचितच पहायला मिळेल असे मला वाटते.

SubQuestion No : 18

Q.18 अदमास लागणे याचा अर्थ सांगा.

- Ans
- 1. गर्दी करणे
 - 2. प्रारंभ होणे
 - 3. अंदाज येणे
 - 4. भांबावून जाणे

Question Type : MCQ

Question ID : 387868430

Option 1 ID : 3878681679

Option 2 ID : 3878681678

Option 3 ID : 3878681677

Option 4 ID : 3878681680

Status : Answered

Chosen Option : 3

Adda247

Comprehension:

दिलेला उतारा वाचा आणि पुढील प्रश्नांची उत्तरे द्या.

ज्या निबिड आणि गगनचुंबी जंगलाबद्दल कारवार प्रसिद्ध आहे त्या जंगलाचा आरंभ हल्याळ पासून होतो. आम्ही हल्याळ सोडले आणि आमच्या प्रवासातील रोमहर्षक खंडाला प्रारंभ झाला. येथपासून सरळ कारवारपर्यंत नव्वद मैल एकसारखे लागून राहिलेले प्रचंड जंगल आलटून पालटून सागाचे आणि बांबूचे आहे. कोणते जंगल कोठे संपते आणि कोठून सुरू होते याचा अदमास लागत नाही. त्याखेरीज नाना जातींचे अनेक उत्तुंग वृक्ष या जंगलात गर्दी करून राहिले आहेत. बांबूचे जंगल सुरू झाले की मैल चे मैल बांबूच्या बेटांखेरीज काही आढळत नाही. एवढे बांबू लावले कोणी आणि त्यांची अवाढव्य वाढ झाली तरी कधी या विचाराने मस्तक गरगरू लागते.

या जंगलाचे वैशिष्ट्य म्हणजे बारीकसारीक झाडाझुडपांना उगवायला येथे वाव नसल्याने हा प्रचंड वृक्षसमूह असूनही त्यांची विशेष गुंतागुंत दिसत नाही. वृक्षांची मस्तके दीडशे फुटांवर एकमेकांत गुंतलेली असली तरी तळचा भाग विरळ आणि मोकळा आहे. सागाचे जंगल सुरू झाले आणि हजारो सरळसोट साग शिपायांच्या पलटणी प्रमाणे जिकडेतिकडे दिसू लागले आणि डोळे भांबावून गेले. असे विलक्षण दृश्य इतरत्र क्वचितच पहायला मिळेल असे मला वाटते.

SubQuestion No : 19

Q.19 हल्याळचे वैशिष्ट्य काय आहे?

- Ans 1. कारवारच्या जंगलाची सुरुवात येथून होते.
2. तेथे वड आणि पिंपळाची जंगले आहेत.
3. वृक्षांच्या मानाने त्यांचा तळचा भाग विरळ आहे.
4. बारीकसारीक झुडुपे तेथे उगवत नाहीत.

Question Type : MCQ

Question ID : 387868429

Option 1 ID : 3878681674

Option 2 ID : 3878681676

Option 3 ID : 3878681675

Option 4 ID : 3878681673

Status : Answered

Chosen Option : 4

Adda247

Comprehension:

दिलेला उतारा वाचा आणि पुढील प्रश्नांची उत्तरे द्या.

ज्या निबिड आणि गगनचुंबी जंगलाबद्दल कारवार प्रसिद्ध आहे त्या जंगलाचा आरंभ हल्याळ पासून होतो. आम्ही हल्याळ सोडले आणि आमच्या प्रवासातील रोमहर्षक खंडाला प्रारंभ झाला. येथपासून सरळ कारवारपर्यंत नव्वद मैल एकसारखे लागून राहिलेले प्रचंड जंगल आलटून पालटून सागाचे आणि बांबूचे आहे. कोणते जंगल कोठे संपते आणि कोठून सुरू होते याचा अदमास लागत नाही. त्याखेरीज नाना जातींचे अनेक उत्तुंग वृक्ष या जंगलात गर्दी करून राहिले आहेत. बांबूचे जंगल सुरू झाले की मैल चे मैल बांबूच्या बेटांखेरीज काही आढळत नाही. एवढे बांबू लावले कोणी आणि त्यांची अवाढव्य वाढ झाली तरी कधी या विचाराने मस्तक गरगरू लागते.

या जंगलाचे वैशिष्ट्य म्हणजे बारीकसारीक झाडाझुडपांना उगवायला येथे वाव नसल्याने हा प्रचंड वृक्षसमूह असूनही त्यांची विशेष गुंतागुंत दिसत नाही. वृक्षांची मस्तके दीडशे फुटांवर एकमेकांत गुंतलेली असली तरी तळचा भाग विरळ आणि मोकळा आहे. सागाचे जंगल सुरू झाले आणि हजारो सरळसोट साग शिपायांच्या पलटणी प्रमाणे जिकडेतिकडे दिसू लागले आणि डोळे भांबावून गेले. असे विलक्षण दृश्य इतरत्र क्वचितच पहायला मिळेल असे मला वाटते.

SubQuestion No : 20

Q.20 'उंच' या अर्थाचा उताऱ्यात कोणता शब्द वापरला आहे?

- Ans
- 1. विलक्षण
 - 2. अवाढव्य
 - 3. रोमहर्षक
 - 4. उत्तुंग

Question Type : MCQ

Question ID : 387868428

Option 1 ID : 3878681672

Option 2 ID : 3878681669

Option 3 ID : 3878681671

Option 4 ID : 3878681670

Status : Answered

Chosen Option : 4

Section : General Knowledge

Q.21 खालीलपैकी कोणत्या वर्षी महाराष्ट्राच्या राज्य निवडणूक आयोगाची स्थापना झाली?

- Ans
- 1. 1996
 - 2. 1994
 - 3. 1990
 - 4. 1992

Question Type : MCQ

Question ID : 387868437

Option 1 ID : 3878681706

Option 2 ID : 3878681705

Option 3 ID : 3878681708

Option 4 ID : 3878681707

Status : Answered

Chosen Option : 2

Q.22 In _____, Marathi language became the official language of the state of Maharashtra.

- Ans
- 1. 1960
 - 2. 1955
 - 3. 1972
 - 4. 1966

Question Type : MCQ
Question ID : 387868440
Option 1 ID : 3878681719
Option 2 ID : 3878681717
Option 3 ID : 3878681718
Option 4 ID : 3878681720
Status : Answered
Chosen Option : 1

Q.23 Which of the following organisations released the Annual Frontiers Report, titled Noise, Blazes, and Mismatches in February 2022?

- Ans
- 1. International Institute for Environment and Development
 - 2. United Nations Environment Programme
 - 3. United Nations Development Programme
 - 4. The Royal Foundation

Question Type : MCQ
Question ID : 387868432
Option 1 ID : 3878681685
Option 2 ID : 3878681687
Option 3 ID : 3878681686
Option 4 ID : 3878681688
Status : Marked For Review
Chosen Option : 2

Q.24 भारतीय वनस्थिती अहवाल 2021 नुसार, राज्यांचा त्यांच्या एकूण भौगोलिक प्रदेशापैकी वनाने व्यापलेल्या जागेच्या टक्केवारीनुसार योग्य तो उतरता क्रम निवडा.

- Ans
- 1. मिझोरम > मेघालय > अरुणाचल प्रदेश
 - 2. मणिपूर > मिझोरम > अरुणाचल प्रदेश
 - 3. मिझोरम > अरुणाचल प्रदेश > मेघालय
 - 4. मेघालय > मिझोरम > अरुणाचल प्रदेश

Question Type : MCQ
Question ID : 387868433
Option 1 ID : 3878681690
Option 2 ID : 3878681692
Option 3 ID : 3878681689
Option 4 ID : 3878681691
Status : Answered
Chosen Option : 3

Q.25 खालीलपैकी कोणते राष्ट्रीय उद्यान महाराष्ट्रात आहे?

- Ans
- 1. सरिस्का व्याघ्र प्रकल्प
 - 2. गीर राष्ट्रीय उद्यान
 - 3. जिम कॉर्बेट राष्ट्रीय उद्यान
 - 4. चांदोली राष्ट्रीय उद्यान

Question Type : MCQ
Question ID : 387868438
Option 1 ID : 3878681712
Option 2 ID : 3878681709
Option 3 ID : 3878681710
Option 4 ID : 3878681711
Status : Answered
Chosen Option : 4

Q.26 महाराष्ट्र विधानसभेच्या जागांची एकूण संख्या _____ आहे.

- Ans
- 1. 288
 - 2. 266
 - 3. 277
 - 4. 255

Question Type : MCQ
Question ID : 387868436
Option 1 ID : 3878681703
Option 2 ID : 3878681701
Option 3 ID : 3878681702
Option 4 ID : 3878681704
Status : Answered
Chosen Option : 1

Q.27 खालीलपैकी कोणत्या फॉर्म्युला वन (Formula 1) चालकाने कॅनेडीयन ग्रँड प्रिक्स 2022 चे जेतेपद मिळवले होते?

- Ans
- 1. जॉर्ज रसेल (George Russell)
 - 2. लुईस हॅमिल्टन (Lewis Hamilton)
 - 3. कार्लोस सेन्झ (Carlos Sainz)
 - 4. मॅक्स वर्स्टापेन (Max Verstappen)

Question Type : MCQ
Question ID : 387868431
Option 1 ID : 3878681684
Option 2 ID : 3878681683
Option 3 ID : 3878681681
Option 4 ID : 3878681682
Status : Marked For Review
Chosen Option : 2

Q.28 _____ ने भारतातील कोणत्याही ATM मधून RuPay-संचालित कार्ड वापरून रोख पेसे काढण्याची सुविधा चालू करणारी पहिली आरबीआय परवानाधारक PPI बनल्याचे जाहीर केले.

- Ans
- 1. कॅशफ्री (Cashfree)
 - 2. फोनपे (PhonePe)
 - 3. रेझरपे (Razorpay)
 - 4. ओम्नीकार्ड (Omnocard)

Question Type : MCQ

Question ID : 387868435

Option 1 ID : 3878681699

Option 2 ID : 3878681700

Option 3 ID : 3878681697

Option 4 ID : 3878681698

Status : Marked For Review

Chosen Option : 2

Q.29 HSBC इंडियाने भारतातील उच्च वाढ असलेल्या आणि तंत्रज्ञान-आधारित स्टार्ट अप योजनांना कर्जपुरवठा करण्यासाठी किती रक्कम जाहीर केली?

- Ans
- 1. \$150 दशलक्ष
 - 2. \$275 दशलक्ष
 - 3. \$125 दशलक्ष
 - 4. \$250 दशलक्ष

Question Type : MCQ

Question ID : 387868434

Option 1 ID : 3878681694

Option 2 ID : 3878681693

Option 3 ID : 3878681695

Option 4 ID : 3878681696

Status : Answered

Chosen Option : 4

Q.30 Which of the following rivers does NOT pass through the state of Maharashtra?

- Ans
- 1. Wardha River
 - 2. Purna River
 - 3. Manjira River
 - 4. Falgu River

Question Type : MCQ

Question ID : 387868439

Option 1 ID : 3878681716

Option 2 ID : 3878681715

Option 3 ID : 3878681713

Option 4 ID : 3878681714

Status : Answered

Chosen Option : 4

Q.31 Select the combination of letters that when sequentially placed in the blanks of the given series will create a repetitive pattern.

--_QRS_TPQ_--TTP_--RSTT_--QRS_T

Ans 1. PQSQTQRQPQT

2. PQTQRSQQPQT

3. PQRSQQPQTQ

4. PRSQQPQTQTQ

Question Type : MCQ

Question ID : 387868445

Option 1 ID : 3878681738

Option 2 ID : 3878681740

Option 3 ID : 3878681739

Option 4 ID : 3878681737

Status : Answered

Chosen Option : 2

Q.32 एका स्त्रीची ओळख करून देताना श्रीमती रत्ना म्हणाल्या, "ती माझ्या आईच्या ब्रदर इन लॉची मोठी मुलगी आहे". तर श्रीमती रत्ना यांचे त्या स्त्रीशी काय नाते आहे?

Ans 1. कड्डीन

2. नीस

3. मुलगी

4. आई

Question Type : MCQ

Question ID : 387868449

Option 1 ID : 3878681753

Option 2 ID : 3878681754

Option 3 ID : 3878681755

Option 4 ID : 3878681756

Status : Answered

Chosen Option : 1

Q.33 काही विद्यार्थी असा खेळ खेळत आहेत ज्यात ते सरळ रेषेत उत्तरेकडे तोंड करून बसले आहेत. हेमंत आणि शीतल यांच्यामध्ये दोन व्यक्ती बसल्या आहेत. बिनोद शीतलच्या डावीकडे पाचव्या स्थानावर बसला आहे. दिनेश डाव्या टोकाला आणि शीतल उजव्या टोकापासून तिसऱ्या स्थानावर बसलेली आहे. फिरोज अमनच्या उजवीकडे दुसऱ्या स्थानावर बसला आहे. अमन आणि दिनेश यांच्यामध्ये दोन व्यक्ती बसल्या आहेत. फिरोज हा अमन आणि विकासच्या अगदी मध्यभागी बसला आहे. तर रांगेत किती लोक बसले आहेत?

Ans 1. 13

2. 17

3. 15

4. 14

Question Type : MCQ

Question ID : 387868442

Option 1 ID : 3878681725

Option 2 ID : 3878681728

Option 3 ID : 3878681727

Option 4 ID : 3878681726

Status : Answered

Chosen Option : 2

Q.34 गोलाकार टेबलाभोवती सहा व्यक्ती A, B, C, D, E आणि F बसलेल्या आहेत. ते सर्व टेबलच्या मध्यभागी तोंड करून बसले आहेत. A हा B आणि E च्या मध्ये बसलेल्या C च्या समोर बसला आहे. F हा B किंवा C यांच्या सोबत बसलेला नाही. B हा A च्या डावीकडे दुसऱ्या स्थानावर बसलेला आहे. A च्या लगोलग उजवीकडे कोण बसले आहे?

- Ans
- 1. B
 - 2. D
 - 3. E
 - 4. F

Question Type : MCQ
Question ID : 387868441
Option 1 ID : 3878681724
Option 2 ID : 3878681722
Option 3 ID : 3878681721
Option 4 ID : 3878681723
Status : Answered
Chosen Option : 2

Q.35 In a certain code language, 'MEDICINE' is written as 'DEFFJJNO' and 'INJECTION' is written as 'DFJJKOOPU'. How will 'DOCTOR' be written in that language?

- Ans
- 1. DEPPSU
 - 2. DE PQSU
 - 3. DERPSU
 - 4. DEPPTU

Question Type : MCQ
Question ID : 387868448
Option 1 ID : 3878681749
Option 2 ID : 3878681750
Option 3 ID : 3878681751
Option 4 ID : 3878681752
Status : Answered
Chosen Option : 1

Adda247

Q.36 Select the figure that will come next in the following figure series.

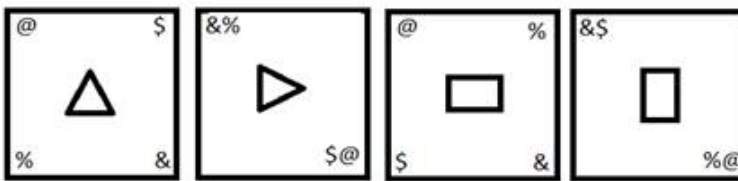

Ans

✗ 1.



✓ 2.



✗ 3.

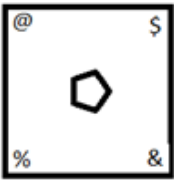

✗ 4.

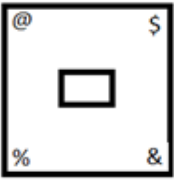

Question Type : MCQ

Question ID : 387868450

Option 1 ID : 3878681759

Option 2 ID : 3878681758

Option 3 ID : 3878681760

Option 4 ID : 3878681757

Status : Answered

Chosen Option : 2

Q.37 जर खाली दिलेल्या शब्दांमधील सर्व स्वर इंग्रजी वर्णमालेतील त्यांच्या नंतरच्या स्वरांनी बदलले असतील आणि सर्व व्यंजने इंग्रजी वर्णमालेतील त्यांच्या आधीच्या व्यंजनांनी बदलली असतील आणि त्यानंतर सर्व शब्द शब्दकोशाच्या क्रमानुसार लिहिले गेले असतील तर खालीलपैकी कोणता शब्द मध्यभागी येईल?

COW, ANT, BUS, CAT, MAT

- Ans 1. ANT
 2. COW
 3. MAT
 4. CAT

Question Type : MCQ

Question ID : 387868447

Option 1 ID : 3878681746

Option 2 ID : 3878681745

Option 3 ID : 3878681748

Option 4 ID : 3878681747

Status : Answered

Chosen Option : 4

Q.38 जर दिलेल्या अक्षर-संख्या-चिन्ह मालिकेचा पहिला अर्धा भाग उलट क्रमाने लिहिला असेल, तर खालीलपैकी कोणते अक्षर/संख्या/चिन्ह उजव्या टोकापासून नवव्या क्रमांकाच्या डावीकडे सहाव्या क्रमांकावर काय असेल?

(डावे) h 4 t 5 6 h y ^ n 5 \$ g t % 4 y % h 3 6 r t e y (उजवे)

- Ans 1. 5
 2. %
 3. t
 4. 4

Question Type : MCQ

Question ID : 387868446

Option 1 ID : 3878681743

Option 2 ID : 3878681741

Option 3 ID : 3878681744

Option 4 ID : 3878681742

Status : Answered

Chosen Option : 3

Q.39 Consider the Venn Diagram below and answer the question that follows.

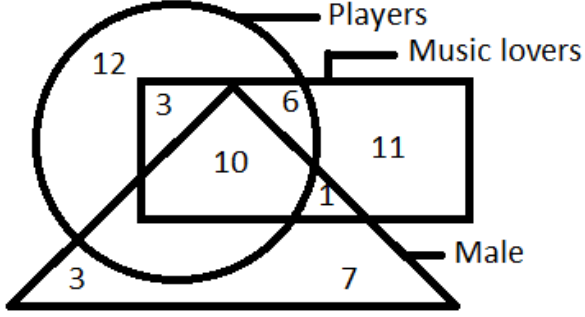

How many music lovers are players but NOT male?

- Ans
- 1. 10
 - 2. 6
 - 3. 9
 - 4. 3

Question Type : MCQ
Question ID : 387868443
Option 1 ID : 3878681732
Option 2 ID : 3878681730
Option 3 ID : 3878681731
Option 4 ID : 3878681729
Status : Answered
Chosen Option : 2

Q.40 परीक्षेनंतर, P चा क्रमांक O च्या वर आणि R चा क्रमांक T च्या वर आला. S चा क्रमांक फक्त एका व्यक्तीपेक्षा कमी आला. Q चा क्रमांक R आणि O या दोन्हीपेक्षा चांगला आला. फक्त एक व्यक्ती O च्या खाली आहे. जर T आणि Q चा समान क्रमांक आहे, तर खालीलपैकी कोणता निष्कर्ष योग्य नाही?

- Ans
- 1. $O < T$
 - 2. $T < P$
 - 3. $S < Q$
 - 4. $Q < P$

Question Type : MCQ
Question ID : 387868444
Option 1 ID : 3878681733
Option 2 ID : 3878681736
Option 3 ID : 3878681734
Option 4 ID : 3878681735
Status : Answered
Chosen Option : 3

Q.41 Which of the following is a primary air pollutant?

- Ans
- 1. Formaldehydes
 - 2. Ozone
 - 3. Sulphuric acid
 - 4. Hydrocarbons

Question Type : MCQ

Question ID : 387868506

Option 1 ID : 3878681984

Option 2 ID : 3878681982

Option 3 ID : 3878681983

Option 4 ID : 3878681981

Status : Marked For Review

Chosen Option : 3

Q.42 In which year was the Motor vehicle Act brought into effect by the Government of India to regulate road traffic in the form of traffic laws, ordinances and regulations?

- Ans
- 1. 1929
 - 2. 1934
 - 3. 1939
 - 4. 1943

Question Type : MCQ

Question ID : 387868486

Option 1 ID : 3878681903

Option 2 ID : 3878681904

Option 3 ID : 3878681902

Option 4 ID : 3878681901

Status : Marked For Review

Chosen Option : 3

Q.43 What is the crippling load (P) for the column whose one end is fixed and the other end is free?

Where E- Young's modulus of elasticity, I- Moment of inertia, l - is the unsupported length of column.

Ans

✗ 1. $P = \frac{4\pi^2 EI}{l^2}$

✗ 2. $P = \frac{2\pi^2 EI}{l^2}$

✗ 3. $P = \frac{\pi^2 EI}{l^2}$

✓ 4. $P = \frac{\pi^2 EI}{4l^2}$

Question Type : MCQ

Question ID : 387868461

Option 1 ID : 3878681803

Option 2 ID : 3878681804

Option 3 ID : 3878681801

Option 4 ID : 3878681802

Status : Answered

Chosen Option : 4

Q.44 Which of the following is NOT an environmental management tool?

Ans

✗ 1. Life cycle assessment

✓ 2. Political assessment

✗ 3. Economic assessment

✗ 4. Environment assessment

Question Type : MCQ

Question ID : 387868502

Option 1 ID : 3878681967

Option 2 ID : 3878681968

Option 3 ID : 3878681966

Option 4 ID : 3878681965

Status : Answered

Chosen Option : 2

Q.45 Find the height of water column corresponding to a pressure of 54 kN/m^2 . Take a specific weight of water equal to 9.81 kN/m^3 .

- Ans
- 1. 5.5 m
 - 2. 6.5 m
 - 3. 3.5 m
 - 4. 4.5 m

Question Type : MCQ
Question ID : 387868474
Option 1 ID : 3878681855
Option 2 ID : 3878681856
Option 3 ID : 3878681853
Option 4 ID : 3878681854
Status : Answered
Chosen Option : 3

Q.46 A unit vector is defined as:

- Ans
- 1. a vector which are parallel to each other
 - 2. a vector which are perpendicular to each other
 - 3. a vector whose magnitude is unity
 - 4. a vector which are acting in the same direction

Question Type : MCQ
Question ID : 387868507
Option 1 ID : 3878681985
Option 2 ID : 3878681987
Option 3 ID : 3878681986
Option 4 ID : 3878681988
Status : Answered
Chosen Option : 3

Q.47 Which of the following is a property of lightweight concrete when compared with normal weight concrete?

- Ans
- 1. High rate of creep
 - 2. Low thermal conductivity
 - 3. Low modulus of elasticity
 - 4. High thermal conductivity

Question Type : MCQ
Question ID : 387868466
Option 1 ID : 3878681821
Option 2 ID : 3878681824
Option 3 ID : 3878681822
Option 4 ID : 3878681823
Status : Marked For Review
Chosen Option : 4

Q.48 As per IS 456:2000, in reinforced concrete beams, the deflection including the effects of temperature, creep and shrinkage occurring after the erection of partitions and the application of finishes should not normally exceed _____ whichever is less.

- Ans**
- 1. span/500 or 40 mm
 - 2. span/350 or 20 mm
 - 3. span/450 or 30 mm
 - 4. span/250 or 10 mm

Question Type : MCQ

Question ID : 387868492

Option 1 ID : 3878681928

Option 2 ID : 3878681926

Option 3 ID : 3878681927

Option 4 ID : 3878681925

Status : Answered

Chosen Option : 2

Q.49 Which of the following is an example of Argillaceous rocks?

- Ans**
- 1. Dolomite
 - 2. Slate
 - 3. Granite
 - 4. Quartzite

Question Type : MCQ

Question ID : 387868451

Option 1 ID : 3878681764

Option 2 ID : 3878681761

Option 3 ID : 3878681762

Option 4 ID : 3878681763

Status : Answered

Chosen Option : 2

- Q.50 A rectangular beam 60 mm wide and 150 mm deep is simply supported over a span of 6 m. If the beam is subjected to central point load of 10 kN, find the maximum bending stress induced in the beam section.

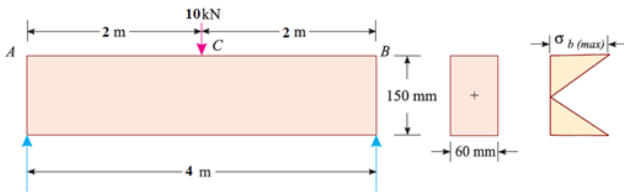

- Ans
- 1. 64.44 MPa
 - 2. 40.00 MPa
 - 3. 35.5 MPa
 - 4. 44.44 MPa

Question Type : MCQ

Question ID : 387868460

Option 1 ID : 3878681800

Option 2 ID : 3878681798

Option 3 ID : 3878681797

Option 4 ID : 3878681799

Status : Answered

Chosen Option : 4

- Q.51 What type of beam is used to connect two spread footing of two-columns?

- Ans
- 1. Lintel beam
 - 2. Strap beam
 - 3. T-beam
 - 4. Plinth beam

Question Type : MCQ

Question ID : 387868453

Option 1 ID : 3878681770

Option 2 ID : 3878681772

Option 3 ID : 3878681771

Option 4 ID : 3878681769

Status : Answered

Chosen Option : 2

Q.52 Which of the following turbines in which the pressure is atmospheric from inlet to the outlet as water flows over the vanes?

- Ans**
- 1. Savonious turbine
 - 2. Pelton turbine
 - 3. Francis turbine
 - 4. Kaplan turbine

Question Type : MCQ

Question ID : 387868472

Option 1 ID : 3878681848

Option 2 ID : 3878681847

Option 3 ID : 3878681846

Option 4 ID : 3878681845

Status : Answered

Chosen Option : 2

Q.53 What type of estimate is required when the sanctioned estimate of the work exceeds by more than 10% of the administration approval?

- Ans**
- 1. Revised estimate
 - 2. Approximate estimate
 - 3. Supplementary estimate
 - 4. Detailed estimate

Question Type : MCQ

Question ID : 387868497

Option 1 ID : 3878681946

Option 2 ID : 3878681948

Option 3 ID : 3878681947

Option 4 ID : 3878681945

Status : Marked For Review

Chosen Option : 1

Q.54 What are the values of fixed end moments at A (M_{AB}) and B (M_{BA}) for the fixed beam shown in the figure?

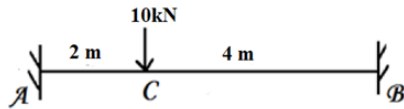

Ans

✓ 1. $M_{AB} = \frac{80}{9} \text{ kN} - m$ and $M_{BA} = \frac{40}{9} \text{ kN} - m$

✗ 2. $M_{AB} = \frac{80}{36} \text{ kN} - m$ and $M_{BA} = \frac{40}{36} \text{ kN} - m$

✗ 3. $M_{AB} = \frac{20}{9} \text{ kN} - m$ and $M_{BA} = \frac{40}{9} \text{ kN} - m$

✗ 4. $M_{AB} = M_{BA} = \frac{60}{36} \text{ kN} - m$

Question Type : MCQ

Question ID : 387868479

Option 1 ID : 3878681876

Option 2 ID : 3878681874

Option 3 ID : 3878681873

Option 4 ID : 3878681875

Status : Marked For Review

Chosen Option : 2

Q.55 Which of the following condition or conditions is true for the identification of zero force member in a truss?

Condition-1: If three members meet at a joint, two of the members are colinear and there is no external force at the joint (applied or reaction), then the third member, out of necessity, must have a zero force.

Condition-2: If two members meet at a joint, they are not colinear and there is no external force at the joint, then out of necessity both member forces must be zero.

Ans

✗ 1. Both conditions are wrong

✗ 2. Condition- 1 is wrong and Condition-2 is true

✓ 3. Both conditions are true

✗ 4. Condition -1 is true and Condition -2 is wrong

Question Type : MCQ

Question ID : 387868481

Option 1 ID : 3878681883

Option 2 ID : 3878681882

Option 3 ID : 3878681884

Option 4 ID : 3878681881

Status : Answered

Chosen Option : 3

Q.56 In which type of soil classification are the soils classified into 18 groups?

- Ans
- 1. Unified soil classification system
 - 2. AASTO soil classification system
 - 3. Indian soil classification system
 - 4. Massachusetts Institute Technology classification system

Question Type : MCQ
Question ID : 387868468
Option 1 ID : 3878681832
Option 2 ID : 3878681831
Option 3 ID : 3878681829
Option 4 ID : 3878681830
Status : Answered
Chosen Option : 3

Q.57 Which of the following rules is INCORRECT when entering measurements in the measurement book?

- Ans
- 1. On the left hand side the measurements and quantity should be entered.
 - 2. Actual measurements only should be entered.
 - 3. On the right hand side the rate and total value should be entered.
 - 4. The entry should be made in pencil only.

Question Type : MCQ
Question ID : 387868499
Option 1 ID : 3878681954
Option 2 ID : 3878681953
Option 3 ID : 3878681956
Option 4 ID : 3878681955
Status : Marked For Review
Chosen Option : 4

Q.58 The zeolite process is used to completely remove the _____ in water.

- Ans
- 1. odour
 - 2. hardness
 - 3. colour
 - 4. turbidity

Question Type : MCQ
Question ID : 387868503
Option 1 ID : 3878681971
Option 2 ID : 3878681972
Option 3 ID : 3878681970
Option 4 ID : 3878681969
Status : Answered
Chosen Option : 2

Q.59 The characteristics of remote sensing image by which the minimum area of the earth's surface can be detected is called:

- Ans
- 1. temporal resolution
 - 2. radiometric resolution
 - 3. spatial resolution
 - 4. spectral resolution

Question Type : MCQ

Question ID : 387868458

Option 1 ID : 3878681790

Option 2 ID : 3878681791

Option 3 ID : 3878681789

Option 4 ID : 3878681792

Status : Marked For Review

Chosen Option : 3

Q.60 Which of the following is the correct formula for calculating loss of head due to bend?

Where V is the velocity of flow, g is the acceleration due to gravity and k is the loss coefficient of the pipe fitting under consideration.

- Ans
- 1. $\frac{2g}{kV^2}$
 - 2. $\frac{V^2}{2g}$
 - 3. $\frac{kV^2}{2g}$
 - 4. $\frac{0.5V^2}{2g}$

Question Type : MCQ

Question ID : 387868473

Option 1 ID : 3878681849

Option 2 ID : 3878681850

Option 3 ID : 3878681851

Option 4 ID : 3878681852

Status : Answered

Chosen Option : 3

Q.61 Find the steepest gradient on a 2° curve for a Broad gauge railway line with a ruling gradient of 1 in 200.

- Ans
- 1. 1 in 231
 - 2. 1 in 238
 - 3. 1 in 230
 - 4. 1 in 235

Question Type : MCQ

Question ID : 387868487

Option 1 ID : 3878681908

Option 2 ID : 3878681905

Option 3 ID : 3878681906

Option 4 ID : 3878681907

Status : Answered

Chosen Option : 2

Q.62 A plane truss is subjected to three-point loads as shown in the below figure, calculate the axial force developed in member DE.

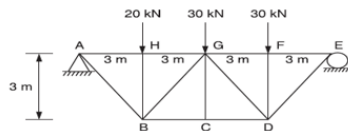

- Ans
- 1. $15.5 * \sqrt{2}$ kN (Tension)
 - 2. $42.5 * \sqrt{2}$ kN (Tension)
 - 3. $37.5 * \sqrt{2}$ kN (Tension)
 - 4. $75.5 * \sqrt{2}$ kN (Tension)

Question Type : MCQ

Question ID : 387868495

Option 1 ID : 3878681939

Option 2 ID : 3878681938

Option 3 ID : 3878681937

Option 4 ID : 3878681940

Status : Answered

Chosen Option : 3

Q.63 Select the INCORRECTLY matched project planning and controlling by PERT and CPM.

Ans 1.

PERT is an event based method and CPM is an activity based method.

2.

PERT is related with activities of uncertain time and CPM is related with activities of well known time.

3.

CPM is developed by Morgan R Walker of DuPont and James E Kelley Jr and PERT is developed by the United States Navy.

4.

CPM is a probabilistic model and PERT is a deterministic model.

Question Type : MCQ

Question ID : 387868484

Option 1 ID : 3878681895

Option 2 ID : 3878681896

Option 3 ID : 3878681893

Option 4 ID : 3878681894

Status : Answered

Chosen Option : 4

Q.64 A plane lamina of 220 mm radius is shown in the figure given below. Find the centroidal distance \bar{y} .

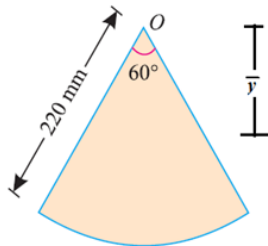

Ans 1. 130 mm

2. 120 mm

3. 140 mm

4. 150 mm

Question Type : MCQ

Question ID : 387868509

Option 1 ID : 3878681994

Option 2 ID : 3878681993

Option 3 ID : 3878681995

Option 4 ID : 3878681996

Status : Marked For Review

Chosen Option : 2

Q.65 The horizontal course of masonry projecting from the face of the wall for shedding rainwater off the face is called:

- Ans
- 1. sill course
 - 2. wall course
 - 3. string course
 - 4. plinth course

Question Type : MCQ

Question ID : 387868454

Option 1 ID : 3878681775

Option 2 ID : 3878681776

Option 3 ID : 3878681774

Option 4 ID : 3878681773

Status : Answered

Chosen Option : 3

Q.66 The IS 456-2000 recommended value of the effective length of an RCC compression member having unsupported length L shown in the figure, effectively held in position at both ends but not restrained against rotation is:

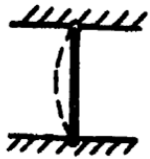

- Ans
- 1. $1.00 L$
 - 2. $0.65 L$
 - 3. $1.50 L$
 - 4. $0.80 L$

Question Type : MCQ

Question ID : 387868496

Option 1 ID : 3878681943

Option 2 ID : 3878681941

Option 3 ID : 3878681944

Option 4 ID : 3878681942

Status : Answered

Chosen Option : 1

Q.67 Match the terminologies and their definitions used in valuations.

terminologies	definitions
1. Sinking fund	A. The capital sum required to be invested in order to receive a net annual income as an annuity of ₹1 at certain rate of interest.
2. Year's purchase	B. The loss in the value of the property due to its use, life, wear, tear etc.
3. Depreciation	C. The loss in the value of the property due to change in fashions, design and structure etc.
4. Obsolescence	D. The amount to be set aside at fixed interval of time for the end of useful life to accumulate to the initial cost of the property.

Ans 1. 1-C; 2-A; 3-B; 4-D

2. 1-B; 2-A; 3-D; 4-C

3. 1-D; 2-C; 3-B; 4-A

4. 1-D; 2-A; 3-B; 4-C

Question Type : MCQ

Question ID : 387868500

Option 1 ID : 3878681957

Option 2 ID : 3878681958

Option 3 ID : 3878681960

Option 4 ID : 3878681959

Status : Answered

Chosen Option : 4

Q.68 An offset is laid out 5° from its true direction on the field. Find the resulting displacement of the plotted point on the paper in a direction parallel to the chain line, given that the length of the offset is 20 m and the scale is 10 m to 1 cm.

Ans 1. $2\sin 5^\circ$ cm

2. $2\tan 5^\circ$ cm

3. $2(1 - \tan 5^\circ)$ cm

4. $2(1 - \cos 5^\circ)$ cm

Question Type : MCQ

Question ID : 387868455

Option 1 ID : 3878681777

Option 2 ID : 3878681779

Option 3 ID : 3878681780

Option 4 ID : 3878681778

Status : Answered

Chosen Option : 3

Q.69 The oil and greases present in waste water is removed through _____.

- Ans
- 1. skimming tanks
 - 2. detritus tanks
 - 3. grit chambers
 - 4. vacuators

Question Type : MCQ

Question ID : 387868504

Option 1 ID : 3878681975

Option 2 ID : 3878681974

Option 3 ID : 3878681973

Option 4 ID : 3878681976

Status : Answered

Chosen Option : 1

Q.70 Find the distribution factors at joint B for a beam shown in the figure below. Assume the same values of modulus of elasticity and moment of inertia, for the spans AB and BC of beams.

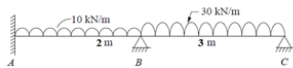

- Ans
- 1. $DF_{BA} = \frac{0.35}{0.75}$ and $DF_{BC} = \frac{0.45}{0.75}$
 - 2. $DF_{BA} = \frac{0.25}{0.75}$ and $DF_{BC} = \frac{0.5}{0.75}$
 - 3. $DF_{BA} = \frac{0.17}{0.75}$ and $DF_{BC} = \frac{0.3}{0.75}$
 - 4. $DF_{BA} = \frac{0.5}{0.75}$ and $DF_{BC} = \frac{0.25}{0.75}$

Question Type : MCQ

Question ID : 387868480

Option 1 ID : 3878681880

Option 2 ID : 3878681878

Option 3 ID : 3878681879

Option 4 ID : 3878681877

Status : Answered

Chosen Option : 4

Q.71 A beam of 3 m long weighing 400 N is suspended in a horizontal position by two vertical strings each of which can withstand a maximum tension of 350 N only, as shown in the figure. How far can a body of 200 N weight be placed on a beam from point A so that one of the strings may just break?

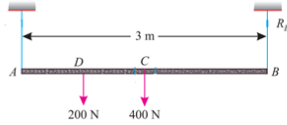

- Ans**
- 1. 0.35 m
 - 2. 0.85 m
 - 3. 0.75 m
 - 4. 0.25 m

Question Type : MCQ

Question ID : 387868510

Option 1 ID : 3878681998

Option 2 ID : 3878681999

Option 3 ID : 3878682000

Option 4 ID : 3878681997

Status : Not Answered

Chosen Option : -

Q.72 Which of the following is observed as a reason for major energy loss inflow of fluids through a pipe?

- Ans**
- 1. Loss of energy due to friction
 - 2. Loss of energy due to sudden enlargement
 - 3. Loss of energy due to bend in pipe
 - 4. Loss of energy due to an obstruction in pipe

Question Type : MCQ

Question ID : 387868491

Option 1 ID : 3878681921

Option 2 ID : 3878681922

Option 3 ID : 3878681923

Option 4 ID : 3878681924

Status : Answered

Chosen Option : 1

Q.73 The condensed polymerisation in building material refers to:

Ans 1.

the process of addition polymerisation of two or more same monomers

2.

the reaction between functional monomer molecules leading to the formation of a polymer with the elimination of some small molecules

3.

the process of simultaneous polymerisation of two or more chemically different monomers

4.

the process of combining two chemically same monomers under high temperature and pressure

Question Type : MCQ

Question ID : 387868452

Option 1 ID : 3878681766

Option 2 ID : 3878681767

Option 3 ID : 3878681765

Option 4 ID : 3878681768

Status : Answered

Chosen Option : 3

Q.74 Which gradient is steeper than the ruling gradient and can be overcome by a train because of the momentum it gathers while running on the section?

Ans 1. Pusher gradient

2. Station gradient

3. Ruling gradient

4. Momentum gradient

Question Type : MCQ

Question ID : 387868489

Option 1 ID : 3878681914

Option 2 ID : 3878681916

Option 3 ID : 3878681913

Option 4 ID : 3878681915

Status : Answered

Chosen Option : 1

Q.75 The drawing to decide the extent of preliminary design to be carried out at the briefing or reporting stage of the construction project is called:

- Ans**
- 1. working drawing
 - 2. tender drawing
 - 3. completion drawing
 - 4. contract drawing

Question Type : MCQ
Question ID : 387868482
Option 1 ID : 3878681885
Option 2 ID : 3878681887
Option 3 ID : 3878681888
Option 4 ID : 3878681886
Status : Answered
Chosen Option : 1

Q.76 What is the maximum slenderness ratio of a steel tension member in which a reversal of direct stress due to loads other than wind or seismic forces occurs?

- Ans**
- 1. 350
 - 2. 400
 - 3. 150
 - 4. 180

Question Type : MCQ
Question ID : 387868493
Option 1 ID : 3878681931
Option 2 ID : 3878681932
Option 3 ID : 3878681929
Option 4 ID : 3878681930
Status : Marked For Review
Chosen Option : 4

Q.77 The following statements are related to the project planning control by network diagrams.

1. The serial activities are those which are to be performed from predecessor to successor.
2. The parallel activities are those which are to be performed simultaneously and independently.

Select the correct option.

- Ans**
- 1. Both statements are true.
 - 2. Statement 1 is wrong and statement 2 is true.
 - 3. Statement 1 is true and statement 2 is wrong.
 - 4. Both statements are wrong.

Question Type : MCQ
Question ID : 387868483
Option 1 ID : 3878681891
Option 2 ID : 3878681890
Option 3 ID : 3878681889
Option 4 ID : 3878681892
Status : Marked For Review
Chosen Option : 1

Q.78 In a levelling work, the staff reading taken to a point of known elevation, so as to determine the height of instrument at an instrument station, is known as:

- Ans**
- 1. height of instrument
 - 2. fore sight
 - 3. change point
 - 4. back sight

Question Type : MCQ
Question ID : 387868456
Option 1 ID : 3878681781
Option 2 ID : 3878681782
Option 3 ID : 3878681783
Option 4 ID : 3878681784
Status : Answered
Chosen Option : 4

Q.79 The magnetic bearing of a line AB shown in the figure is S 28° 30' E. Calculate the true bearing if the declination is 7° 30' West.

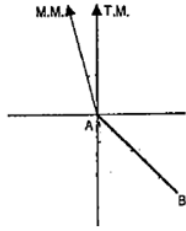

- Ans
- ✓ 1. S 36° 00' E
 - ✗ 2. N 21° 00' W
 - ✗ 3. S 21° 00' E
 - ✗ 4. N 36° 00' E

Question Type : MCQ

Question ID : 387868457

Option 1 ID : 3878681785

Option 2 ID : 3878681788

Option 3 ID : 3878681786

Option 4 ID : 3878681787

Status : Marked For Review

Chosen Option : 3

Q.80 Cantilever beam of length l carrying uniformly distributed load (w/m) is shown in the figure. What is the maximum deflection at the free end B where EI is the flexure rigidity?

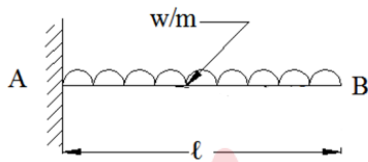

- Ans
- ✓ 1. $\frac{wl^4}{8EI}$
 - ✗ 2. $\frac{wl^4}{4EI}$
 - ✗ 3. $\frac{wl^4}{12EI}$
 - ✗ 4. $\frac{wl^3}{6EI}$

Question Type : MCQ

Question ID : 387868478

Option 1 ID : 3878681869

Option 2 ID : 3878681871

Option 3 ID : 3878681870

Option 4 ID : 3878681872

Status : Marked For Review

Chosen Option : 1

Q.81 What is the unit of measurement of Damp proof course having cement concrete of 4 cm thick and 1 : 2 : 4 mix with one coat of bitumen?

- Ans**
- 1. Kilogram
 - 2. Cubic metre
 - 3. Square metre
 - 4. Running metre

Question Type : MCQ
Question ID : 387868498
Option 1 ID : 3878681952
Option 2 ID : 3878681951
Option 3 ID : 3878681950
Option 4 ID : 3878681949
Status : Marked For Review
Chosen Option : 3

Q.82 According to IS 456-2000, the maximum permissible limit of chloride impurities in present portable water used for plain concrete mixing is:

- Ans**
- 1. 500 mg/l
 - 2. 2000 mg/l
 - 3. 200 mg/l
 - 4. 1000 mg/l

Question Type : MCQ
Question ID : 387868464
Option 1 ID : 3878681814
Option 2 ID : 3878681816
Option 3 ID : 3878681813
Option 4 ID : 3878681815
Status : Marked For Review
Chosen Option : 2

Q.83 Oven-dried soil having a mass of 200 g is placed in a pycnometer, which is then completely filled with water. The total mass of the pycnometer with water and soil inside is 1600 g. The mass of the pycnometer filled with water alone is 1500 g. Calculate the specific gravity of soil.

- Ans**
- 1. 2.0
 - 2. 2.50
 - 3. 1.5
 - 4. 2.25

Question Type : MCQ
Question ID : 387868471
Option 1 ID : 3878681842
Option 2 ID : 3878681844
Option 3 ID : 3878681841
Option 4 ID : 3878681843
Status : Not Answered
Chosen Option : -

Q.84 Consider the following project network in which project activities A, B, C, D, E, F and J are shown in circles with their expected time of completion in days. Determine the critical path and the project duration.

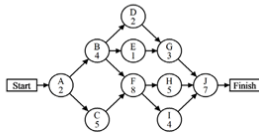

Ans 1.

The critical path is A–C–F–H–J with a completion time of 27 days.

2.

The critical path is A–B–D–G–J with a completion time of 27 days.

3.

The critical path is A–C–F–H–J with a completion time of 28 days.

4.

The critical path is A–B–E–G–J with a completion time of 28 days.

Question Type : MCQ

Question ID : 387868485

Option 1 ID : 3878681898

Option 2 ID : 3878681900

Option 3 ID : 3878681897

Option 4 ID : 3878681899

Status : Answered

Chosen Option : 1

Q.85 According to IS456-2000, the design bond stress in the limit state method for plain bars in tension for M30 grade concrete shall be:

Ans 1. 1.5 N/mm^2

2. 1.9 N/mm^2

3. 1.7 N/mm^2

4. 1.2 N/mm^2

Question Type : MCQ

Question ID : 387868494

Option 1 ID : 3878681934

Option 2 ID : 3878681936

Option 3 ID : 3878681935

Option 4 ID : 3878681933

Status : Marked For Review

Chosen Option : 3

Q.86 Match List-I (Laws) with List-II (Phenomena) and select the correct answer using the codes given below the lists:

Laws	phenomena
A. Hydrostatic law	1. Pressure at a point is equal in all directions in a fluid at rest.
B. Newton's law	2. The total energy at a point is constant.
C. Pascal's law	3. Rate of change of pressure in a Vertical direction is proportional to specific weight of fluid.
D. Bernoulli's law	4. Shear stress is directly proportional to velocity gradient in fluid flow.

- Ans
- 1. A-3; B-1; C-4; D-2
 - 2. A-3; B-4; C-1; D-2
 - 3. A-4; B-3; C-1; D-2
 - 4. A-2; B-4; C-1; D-3

Question Type : MCQ

Question ID : 387868475

Option 1 ID : 3878681857

Option 2 ID : 3878681859

Option 3 ID : 3878681860

Option 4 ID : 3878681858

Status : Answered

Chosen Option : 2

Q.87 Match the following admixtures with chemicals.

admixtures	chemicals
1. Air detrained admixture	A. Sodium Nitrate
2. Gas forming admixture	B. Gels
3. Corrosion inhibiting admixtures	C. Try butyl phosphate
4. Grouting admixture	D. Aluminium powder

- Ans
- 1. 1-C; 2-A; 3-D; 4-B
 - 2. 1-D; 2-C; 3-A; 4-B
 - 3. 1-C; 2-D; 3-A; 4-B
 - 4. 1-C; 2-D; 3-B; 4-A

Question Type : MCQ

Question ID : 387868467

Option 1 ID : 3878681826

Option 2 ID : 3878681825

Option 3 ID : 3878681827

Option 4 ID : 3878681828

Status : Answered

Chosen Option : 3

Q.88 The following statements are related to the curing of concrete. Select the correct option from the following:

1. Concrete cured at higher temperatures initially leads to lower early strengths.
2. Curing is a process that facilitates hydration.

- Ans**
- 1. Statement-1 is false and statement-2 is true.
 - 2. Statement-1 is true and statement-2 is false.
 - 3. Both statements are true.
 - 4. Both statements are false.

Question Type : MCQ

Question ID : 387868465

Option 1 ID : 3878681818

Option 2 ID : 3878681817

Option 3 ID : 3878681819

Option 4 ID : 3878681820

Status : Marked For Review

Chosen Option : 3

Q.89 Which of the following beams is a statically determinate beam?

- Ans**
- 1. Fixed beam
 - 2. Cantilever beam
 - 3. Continuous beam
 - 4. Propped cantilever beam

Question Type : MCQ

Question ID : 387868477

Option 1 ID : 3878681865

Option 2 ID : 3878681868

Option 3 ID : 3878681866

Option 4 ID : 3878681867

Status : Answered

Chosen Option : 2

Q.90 What is the purpose of providing rack railways?

Ans 1.

Rack railways are provided to push the locomotive train by adding an additional engine when the gradient is much steeper than 3%.

2.

Rack railways are provided to avoid the locomotive train sliding down or slipping back along the downgrade when the gradient is much steeper than 3%.

3.

Rack railways are provided to avoid the locomotive train sliding down or slipping down when the train is moving at a faster speed on a flat surface.

4.

Rack railways are provided to avoid the locomotive train sliding down or slipping down at the crossing.

Question Type : MCQ

Question ID : 387868490

Option 1 ID : 3878681917

Option 2 ID : 3878681918

Option 3 ID : 3878681920

Option 4 ID : 3878681919

Status : Answered

Chosen Option : 2

Q.91 A steel rod 1 m long and 20 mm × 20 mm in cross-section is subjected to a tensile force of 40 kN. Determine the elongation of the rod, if the modulus of elasticity for the rod material is 200 GPa.

Ans 1. 0.75 mm

2. 0.50 mm

3. 0.25 mm

4. 1.00 mm

Question Type : MCQ

Question ID : 387868462

Option 1 ID : 3878681807

Option 2 ID : 3878681806

Option 3 ID : 3878681805

Option 4 ID : 3878681808

Status : Answered

Chosen Option : 2

Q.92 A branch of science which deals with the interactions between living organisms and their physical environment is called:

- Ans**
- ✓ 1. ecology
 - ✗ 2. hydrology
 - ✗ 3. hydrogeology
 - ✗ 4. glaciology

Question Type : MCQ
Question ID : 387868501
Option 1 ID : 3878681962
Option 2 ID : 3878681961
Option 3 ID : 3878681963
Option 4 ID : 3878681964
Status : Answered
Chosen Option : 1

Q.93 The ratio of change in void ratio to the change in effective stress is called:

- Ans**
- ✗ 1. coefficient of hydraulic conductivity
 - ✗ 2. coefficient of permeability
 - ✗ 3. coefficient of volume change
 - ✓ 4. coefficient of compressibility

Question Type : MCQ
Question ID : 387868470
Option 1 ID : 3878681840
Option 2 ID : 3878681838
Option 3 ID : 3878681837
Option 4 ID : 3878681839
Status : Answered
Chosen Option : 4

Q.94 Find the moment of inertia of a rectangle shown in the figure about the axis AB.

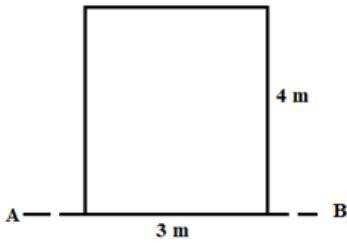

- Ans
- 1. 16 m^4
 - 2. 36 m^4
 - 3. 64 m^4
 - 4. 84 m^4

Question Type : MCQ

Question ID : 387868459

Option 1 ID : 3878681793

Option 2 ID : 3878681794

Option 3 ID : 3878681795

Option 4 ID : 3878681796

Status : Answered

Chosen Option : 3

Q.95 According to the National building code of India: 2016 (volume 1- part 4), which of the following types of buildings are classified as group B buildings?

- Ans
- 1. Institutional
 - 2. Business
 - 3. Educational
 - 4. Residential

Question Type : MCQ

Question ID : 387868488

Option 1 ID : 3878681910

Option 2 ID : 3878681911

Option 3 ID : 3878681912

Option 4 ID : 3878681909

Status : Marked For Review

Chosen Option : 1

Q.96 If R is the radius of a circular channel, d is the depth of water and 2θ is the angle subtended by water surface AB at the centre in radians as shown in the figure. What does the hydraulic radius mean?

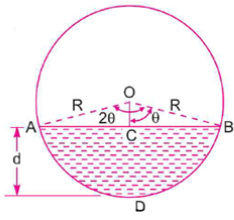

Ans

1. $\frac{R}{2\theta} \left(\sin\theta - \frac{\sin 2\theta}{2} \right)$

2. $\frac{R}{2\theta} \left(\theta - \frac{\sin 2\theta}{2} \right)$

3. $\frac{R}{\theta} \left(\theta - \frac{\sin 2\theta}{2} \right)$

4. $\frac{R}{2\theta} \left(\theta - \frac{\sin \theta}{2} \right)$

Question Type : MCQ

Question ID : 387868476

Option 1 ID : 3878681863

Option 2 ID : 3878681864

Option 3 ID : 3878681862

Option 4 ID : 3878681861

Status : Answered

Chosen Option : 1

Q.97 The branch of engineering mechanics that deals with the forces and their effect acting upon the body at rest are called:

Ans 1. dynamics

2. statics

3. statistics

4. kinematics

Question Type : MCQ

Question ID : 387868508

Option 1 ID : 3878681989

Option 2 ID : 3878681990

Option 3 ID : 3878681991

Option 4 ID : 3878681992

Status : Answered

Chosen Option : 2

Q.98 The void ratio of alluvium soil is 80% with a water content of 30%. Find the degree of saturation of the soil if the specific gravity of soil is 2.

- Ans
- 1. 75%
 - 2. 60%
 - 3. 85%
 - 4. 70%

Question Type : MCQ
Question ID : 387868469
Option 1 ID : 3878681835
Option 2 ID : 3878681833
Option 3 ID : 3878681836
Option 4 ID : 3878681834
Status : Answered
Chosen Option : 1

Q.99 The following statements are related to municipal solid waste. Select the correct option.

1. The garbage includes all sorts of putrescible organic wastes obtained from kitchens , hotels, restaurants etc.
2. Rubbish include solid wastes originating in households, commercial establishments and institutions excluding garbage and ashes.

- Ans
- 1. Both statements are false.
 - 2. Statement 1 is false and Statement 2 is true.
 - 3. Both statements are true.
 - 4. Statement 1 is true and Statement 2 is false.

Question Type : MCQ
Question ID : 387868505
Option 1 ID : 3878681980
Option 2 ID : 3878681978
Option 3 ID : 3878681979
Option 4 ID : 3878681977
Status : Answered
Chosen Option : 3

Q.100 Which of the following Bogue compound is called 'Alite' formed during clinkering process of cement?

- Ans
- 1. Tricalcium aluminate
 - 2. Dicalcium silicate
 - 3. Tetracalcium Alumino Ferrite
 - 4. Tricalcium silicate

Question Type : MCQ
Question ID : 387868463
Option 1 ID : 3878681811
Option 2 ID : 3878681809
Option 3 ID : 3878681812
Option 4 ID : 3878681810
Status : Answered
Chosen Option : 4